

Population

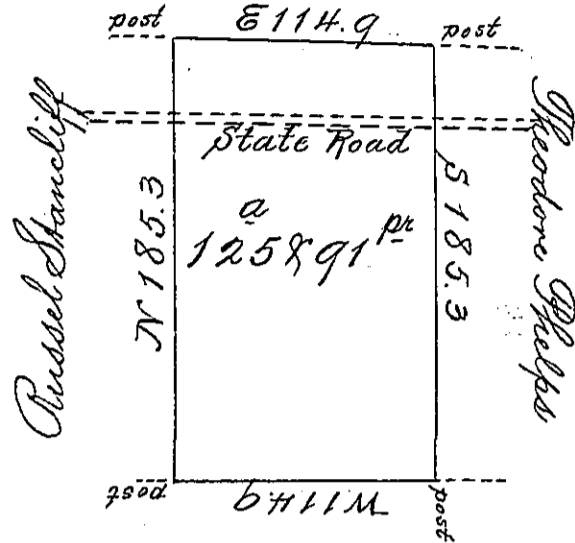

John Howard Mangum
of Erie & Woodworth

A Draught of a Tract of Land situated in Wash-
 ington Township Erie Co. on the waters of Little Coneottee
 Creek Surveyed January 15th 1835 for William E. M. Nair
 in pursuance of his Warrant for the same bearing date 13th
 Nov^r A.D. 1834 & Containing One hundred & Twenty five
 acres & Ninety one perches with the usual alleys &c

To Jacob Spangler Esq. S. G.

Cyrenius E. Webster of
Erie

20th January A.D. 1835

IN TESTIMONY that the above is a copy of the original remaining on file in
 the Department of Internal Affairs of Pennsylvania, made
 conformably to an Act of Assembly approved the 16th day of
 February, 1833, I have hereunto set my Hand and caused
 the Seal of said Department to be affixed at Harrisburg,
 this seventh day of October 1902.

James W. Latta
 Secretary of Internal Affairs.